

ArtWRAP Canvas Framing System

Assembly Instructions

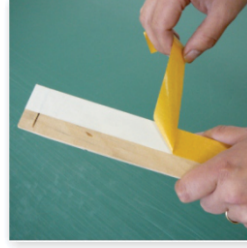

1. Your image must be larger than your stretcher bars by the following amount:
 $1\frac{1}{2}$ " stretchers add $3\frac{1}{4}$ "
 To staple your substrate to the back of the frame leave an even $\frac{3}{4}$ " of material all around



2. Remove the adhesive strip cover from all of the bars.

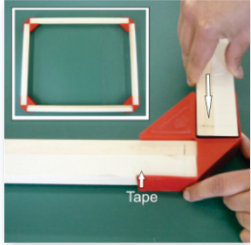

3. Insert the stretchers into the ProCORNERS corner clamps so that the adhesive strip is facing up and towards outside edge. There is a slot on the stretcher bar that must align with a tab on the ProCORNERS to ensure proper positioning. If they are not aligned, the stretcher bar will not go into the clamp.



4. Centre the stretcher assembly over the substrate. Make sure that the stretcher bars land inside the material and that there is a little left for trimming.



5. Start by pushing the bars that are opposite to each other down so that the adhesive makes contact with your substrate. Repeat for the other sides.

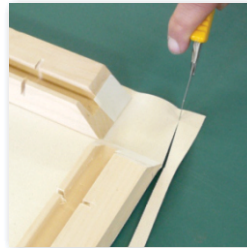

6. Remove the corner jigs by pulling up while holding the stretchers down. Trim off excess material and make sure to angle the cut a little inward when you reach the corner.

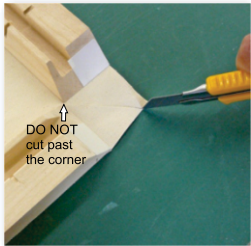

7. Cut the corner from where the stretchers meet outwards at 45° .

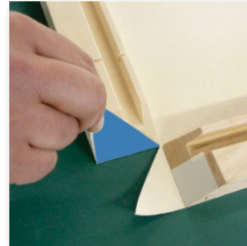

8. Fold the corners onto the adhesive ends.



9. **IMPORTANT!**
 Run a small bead of glue along the inside of the stretcher bars.

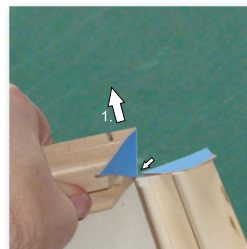

10. Bring the bars up to close the frame and insert staple. On the last two corners, force the bars that are up outwards (1.) to prevent the substrate from pinching at the corner (2.)



11. Insert the corner braces into the groove on the inside of the stretcher frame. Gently hammer the braces towards to corners to increase tension.



12. Insert centre brace if required.



INNOVATIVE SIGNAGE PRODUCTS